



CDVI

Security to Access



RX CUBE

SIGNAL

1 Introduction

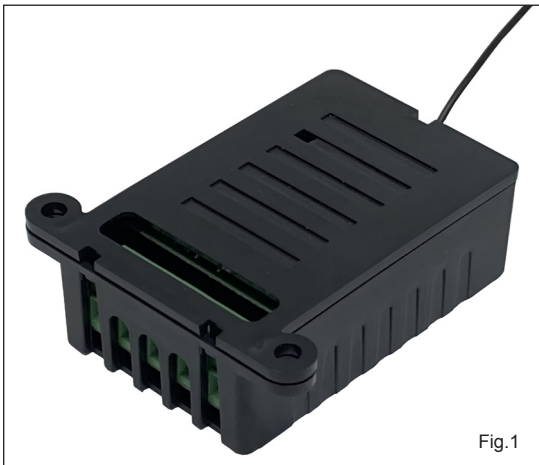

Fig.1

RX CUBE SIGNAL - Bluetooth controlled radio receiver

The receiver ERONE “Cube Signal” is a superheterodyne radio receiver operating at 433,92 MHz in AM/ASK demodulation.

It is compatible with the full range of remote controls Erone that use the Keeloq® Hopping code security protocol.

This receiver can be programmed only via Bluetooth using set-up and control that can be done only using the app : “RX Cube” on a Smartphone (iOS or Android).

Power supply 12-24 Vac/dc autodetect. High power output contacts
The equipment is manufactured in compliance with the provisions of European Directive 2014/30/EU, 2014/35/EU, 2014/53/EU and the provisions of the standard EN 62368-1.

Part-name	F-code	Description
SEL2641R433-RC	F1001000105	RECEIVER CUBE BT 12/24V

2 Technical Specifications

- Receiver type..... Superheterodyne
- Operating frequency 433,92 MHz - AM/ASK
- Input sensitivity -118 dBm
- Input load: 50 Ohm
- Power supply: 12 - 24 Vac/dc (autodetect)
- Consumption max:..... 78 mA @12Vac
- Peak consumption 500 mA at power up
- Max switching power: 1 A @ 24V (max 60 V)
- Relay number: 1
- Operating modes: Pulse / Latch / Timed
- Release time (Timed mode): from 1 sec. to 23h.59m:59s
- Contacts: C-NO-NC
- Memory capacity: 250 TX codes, 100 Smartphones
- TX security code:..... KeeLoq® Hopping code
- Smartphones security code:..... AES128
- Max code combination number: 2⁶⁴
- Operating temperature: -20°/+65°C
- Housing protection: IP2X
- Overall dimensions: 50 x 32 x 20 mm
- Communication w/mobile phone: ... Bluetooth
- Standard:..... BLE 4.2
- IO : Compatibility:..... Android,iOS
- Release Android: 6.0 and next
- Release iOS: 13 and next



3 Dimensions

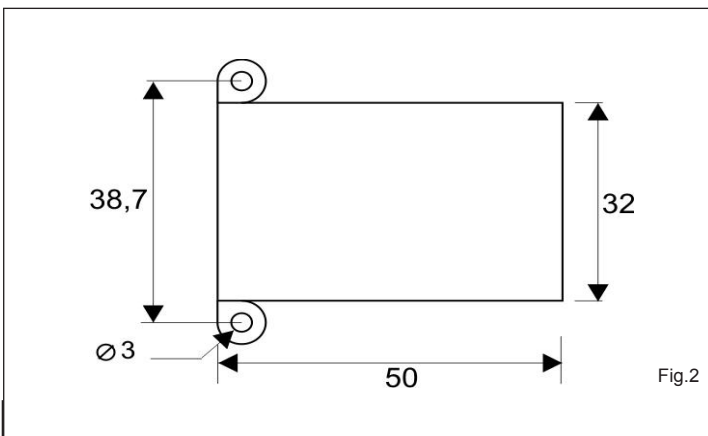

Fig.2

4 Warnings



The receiver allocation is very important for the best operation of the system. Place the receiver far from interference sources such as big magnetic fields or radio emissions. The distance between 2 receivers must be at least 1,5 m.

- The equipment must be powered from a device that provides a safety extra low voltage (SELV) type LPS (Low Power Source);
- There must be a suitable disconnecting device to the current drawn by the receiver (90 mA max @ 12Vdc).

5 Wiring

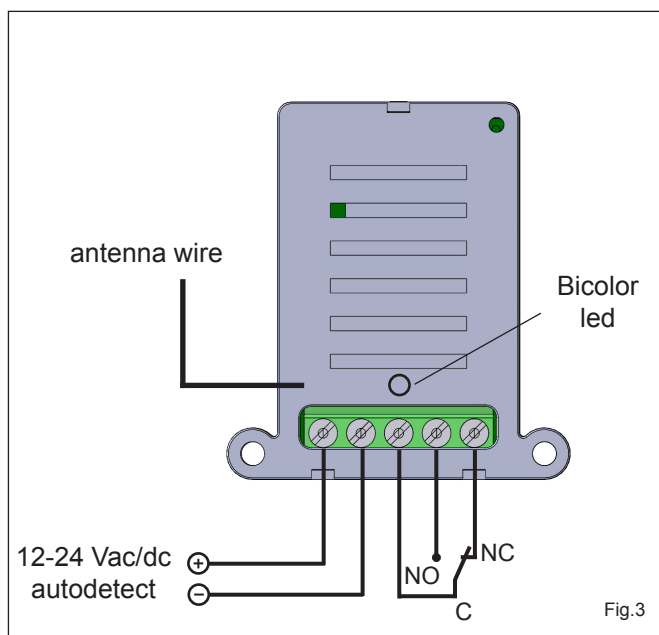

6 Legenda LED

Color LED	Description
Green	Power ON NO Bluetooth communication
Green-Orange blinking	Bluetooth communication in progress
Orange	Relay excited

7 The App “RxCube”

The setup of the receiver can be done only through the App “RxCube”. Once downloaded, authorize the App to use the Bluetooth communication. The App will ask even the GPS localization: please authorize it for the full operating of the Bluetooth BLE.

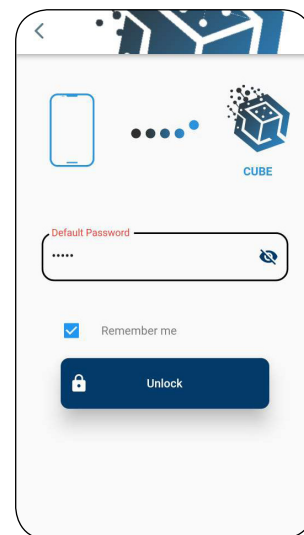
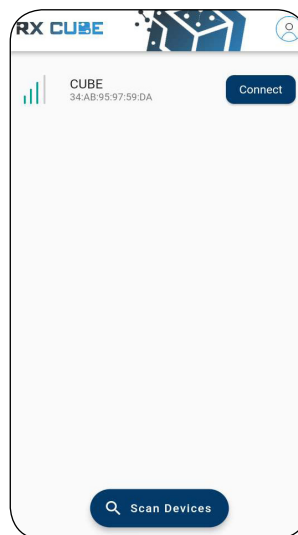
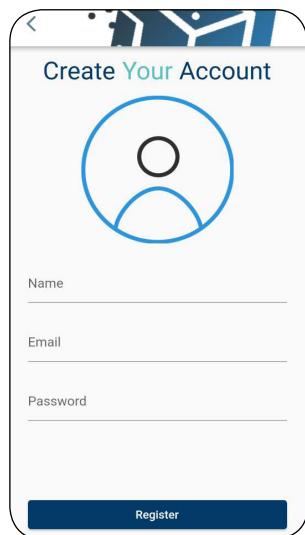
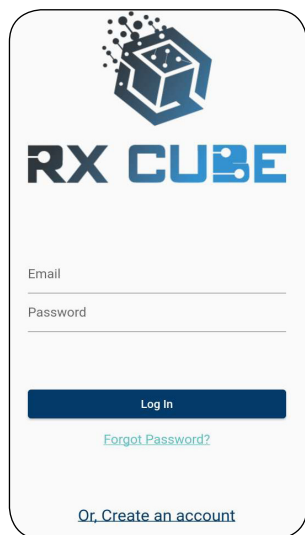

On the very first access you have to create your account. Once your profile is verficated via email, you can start using the app.

Press the scan button and connect to the receiver to configure it. The range of the scanning is limited by the Bluetooth technology (10 -- 30 m). Much depends by the fixing position of the receiver and whether the communication is direct or passes through walls.



The receiver, by factory, comes with the name “CUBE” and default password values (11111 for Administrators, 00000 for Installers). It is highly reccomanded to change the passwords since the first access to the device. The name of the device can have up to 12 characters.

7.1 Home Page

Once successfully connected to the receiver, the app will open to the device's home page. From now on, it is possible to manage the receiver and its functionalities.

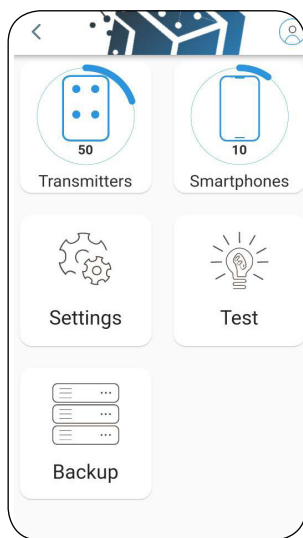

HOME

In the device home page, you can see the memory situation: how many phones and how many transmitters are stored.

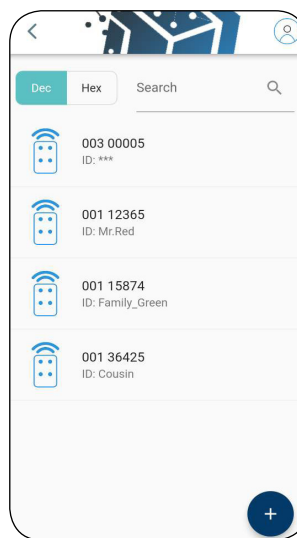

TRANSMITTERS

Section dedicated to the management of the transmitter memory. Addition, removal or modification of the single transmitter or the block. You can also attribute a name ("ID") to each TX to understand who it belongs to.

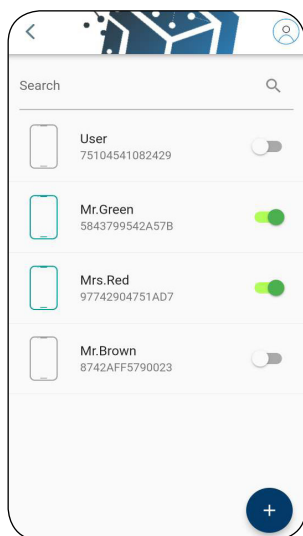

SMARTPHONES

Section dedicated to the management of the smartphone memory. Addition, removal, enable or modification the smartphones.

Each smartphone is defined by a unique code (UserCode) and a UserName.

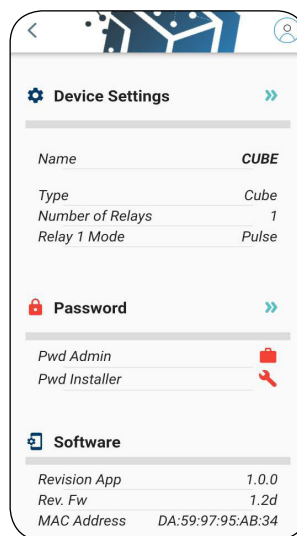

SETTINGS

Area for setting relay mode, passwords and receiver name. Technical data and information regarding the receiver CUBE.

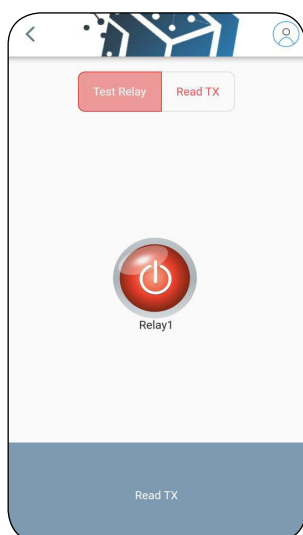

TEST

Area dedicated to the testing of relay and TX:

- **Test Relay:**
Verification of the correct activation

- **Read TX:**
To get all the information of a TX, hold one of its buttons.

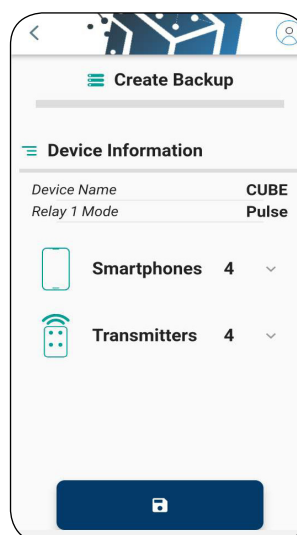

BACKUP

Creation of backup copies of the memory.

Restore the memory from a backup of the same receiver or a different receiver.

7.2 Transmitters management

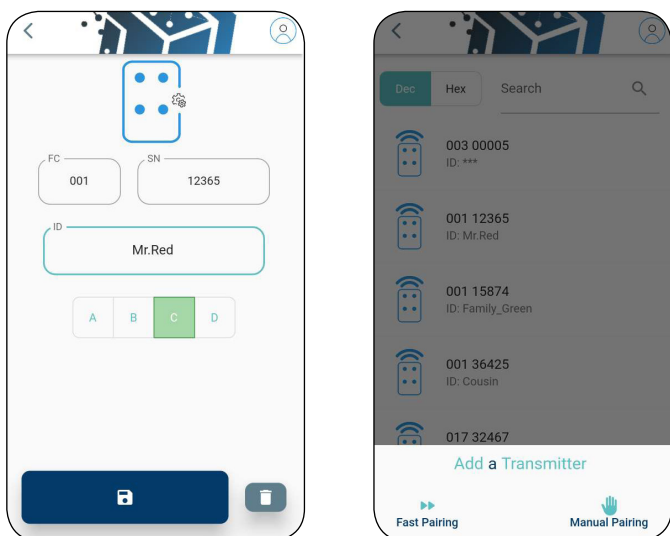

Add, delete or change the transmitter parameters (ID or buttons choice).

Two ways to add one or more transmitters:

- Fast Pairing:

Receiver will be setted in “listening mode” and will memorize all the buttons that are pressed.

- Manual Pairing:

Manual entry of Facility Code, Serial Number (in Hexadecimal or decimal) ID and buttons.

7.3 Smartphones management

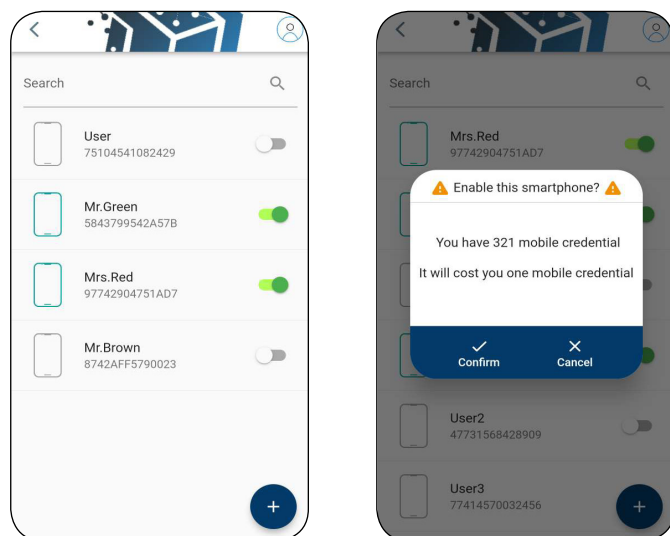

See the list of stored Smartphones. With a search bar you can filter them or search for a specific one. Add, delete or change the smartphone parameter (UserName).

Enable a smartphone for the relay activation (with UserCube APP) consuming one mobile credential.

Note: Disabling a smartphone will give back one mobile credential.

7.4 Device Settings

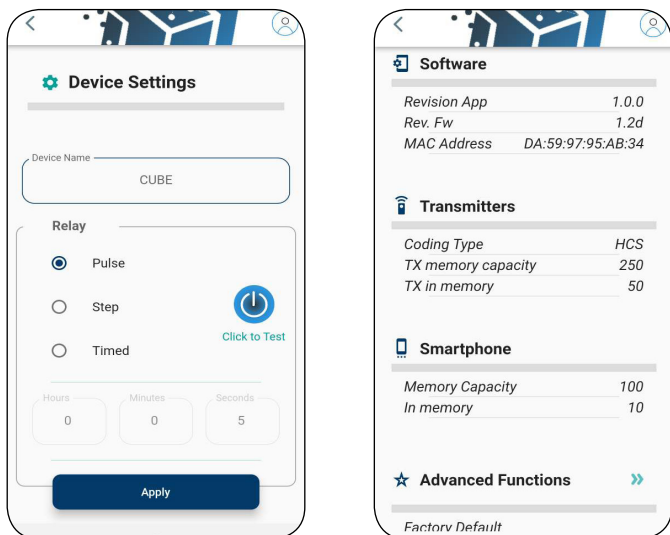

Set or change the name of the receiver. Set the relay operating mode: PULSE, LATCH, TIMED. In Timed mode, it is possible to set the relay release time from 1 sec. to 23h : 59m : 59s. Collection of all the information regarding the receiver (passwords, software version, coding type etc..)

7.5 Test

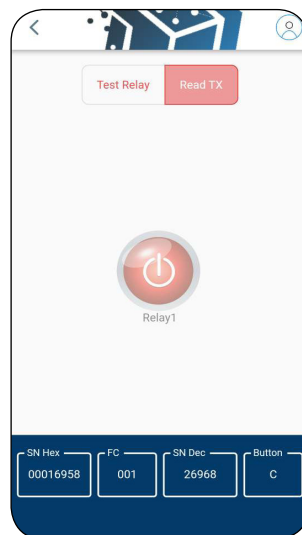

Direct activation of the relay for testing it.

Display of the transmitter Serial Number

7.6 Backup

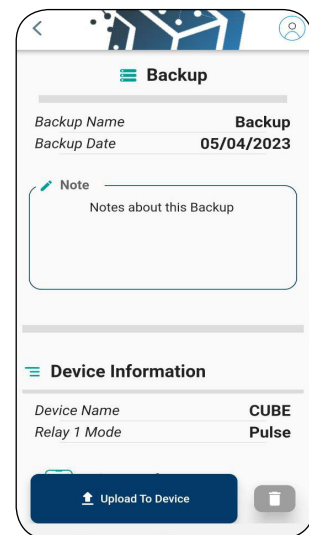

Warning: the upload of the backup will overwrite the actual memory of the receiver.

8 The App “UserCube”

App for final Users. It allows the activation of the receiver relay from the smartphone. UserCube transforms the user’s smartphone in a Bluetooth remote control, with its own Serial Number (called UserCode) and an ID (UserName).

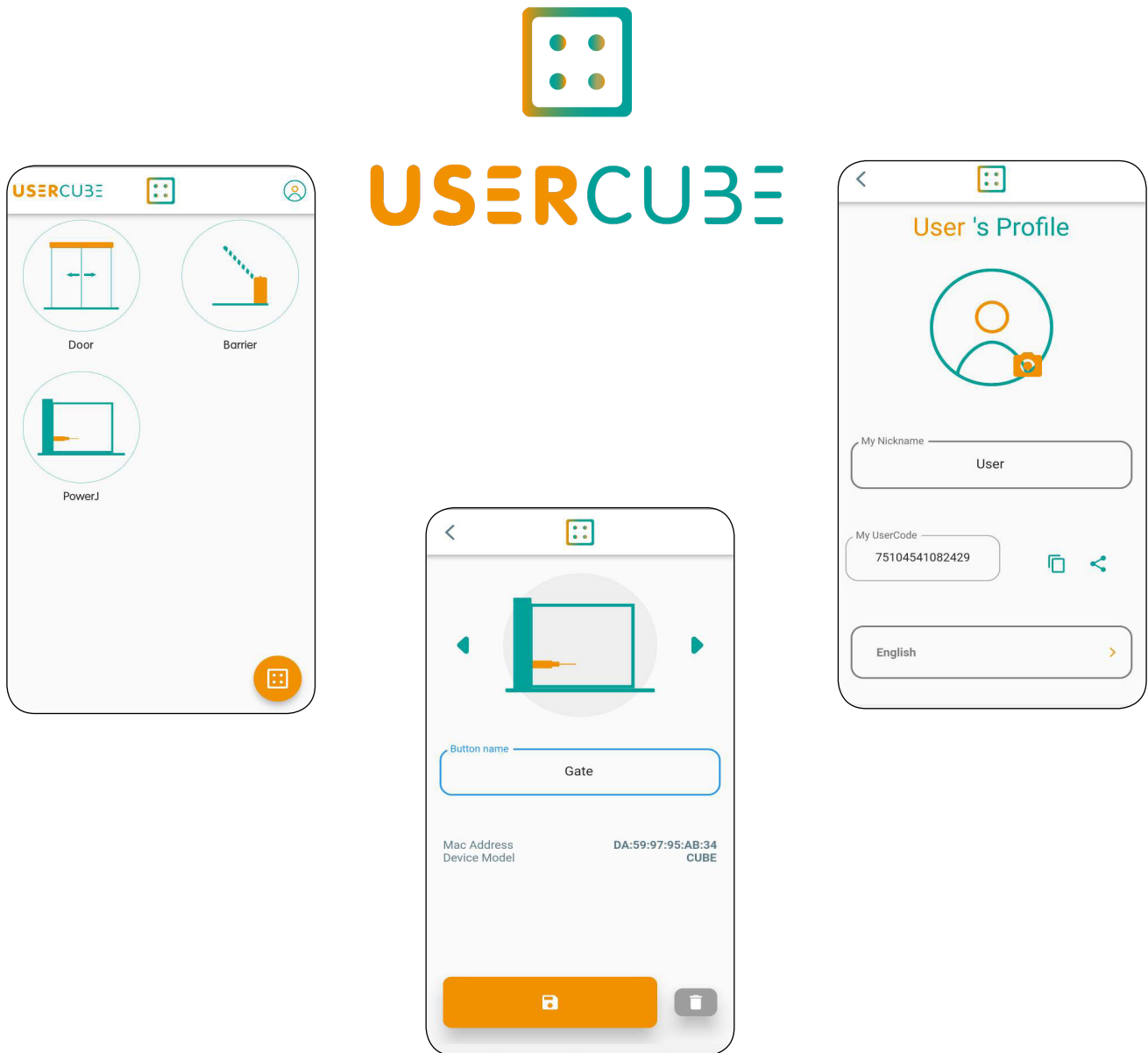

The User sends his own UserCode to the installer. The Installer memorizes and enables it (consuming a mobile credential). The User, than, has just to connect to the receiver, the app will do the rest. If the Smartphone is memorized and correctly enabled, it will be created a button. The User can personalize it changing the icon or the name.

9 Mobile Credentials Cards

Mobile Credentials are the virtual token that installer uses to enable smartphones. They can be acquired by NFC Card directly with the app RxCube



Part-name	F-code	Description
CMC5	F1002000138	NFC MOBILE CARD FOR RX CUBE - 5 LICENCES
CMC10	F1002000139	NFC MOBILE CARD FOR RX CUBE - 10 LICENCES
CMC25	F1002000140	NFC MOBILE CARD FOR RX CUBE - 25 LICENCES

10 Disposal



This product is made up of various types of material, therefore, as indicated by the symbol in the figure, the product must not be disposed of in with the household waste. Dispose in accordance with local current regulations.

11 Guarantee

The warranty period for this product is 60 months, beginning from the manufacturer date. During this period, if the product does not work correctly, due to a defective component, the product will be repaired or substituted at our discretion. The guarantee does not cover the plastic container integrity. After-sale service is supplied at the factory.

IS-RC24ERML rev.1 on 27/04/2023



Manufactured by : CDVI WIREless SPA - Via Piave, 23
 31020 S.Pietro di Feletto (TV) - Italy
 Tel : +39-0438-450960 - Fax : +39-0438-455628
 web: www.erone.com - email: info@erone.com

CDVI AMERICAS

[CANADA - USA - LATIN AMERICA]
www.cdvi.ca

CDVI BENELUX

[BELGIUM - NETHERLAND - LUXEMBOURG]
www.cdviBenelux.com

CDVI FRANCE

www.cdvi.com

CDVI IBÉRICA

[SPAIN - PORTUGAL]
www.cdviIberica.com

CDVI ITALIA

www.cdvi.it

CDVI MAROC

www.cdvi.ma

CDVI POLSKA

www.cdvi.com.pl

CDVI SUISSE

[SWITZERLAND]
www.cdvi.ch

CDVI NORDIC

[SWEDEN - DENMARK - NORWAY - FINLAND]
www.cdvi.se

CDVI UK

[UNITED KINGDOM - IRELAND - SOUTH AFRICA]
www.cdvi.co.uk

CDVI WIRELESS

www.erone.com

www.erone.com